

Tempe Mission Palms Hotel

1st Floor

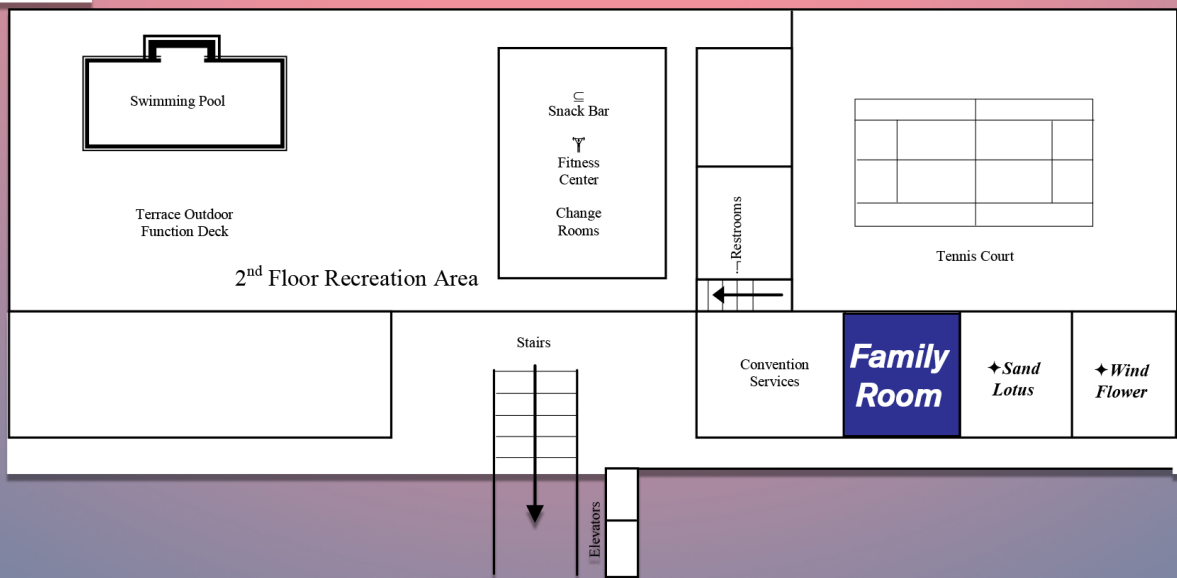

2nd Floor



**A Lactation Room is Available in Room 2056
Please ask the Front Desk for the key**



**CULTURAL
EVOLUTION
SOCIETY**

CES2018

October 22 - 24
TEMPE, AZ

complexity.asu.edu/ces

Code of Conduct

CES is dedicated to providing a welcoming and harassment-free conference experience for everyone, regardless of gender, gender identity and expression, sexual orientation, disability, physical appearance, body size, race, age, religion, nationality, or the presence of or care for dependents. We do not tolerate harassment of conference participants in any form. Conference participants violating these rules may be sanctioned or expelled from the conference at the discretion of the conference organizers.

Harassment includes, but is not limited to:

- Verbal comments that reinforce social structures of domination related to gender, gender identity and expression, sexual orientation, disability, physical appearance, body size, race, age, religion, nationality
- Sexual images in public spaces
- Deliberate intimidation, stalking, or following
- Harassing photography or recording
- Sustained disruption of talks or other events
- Inappropriate physical contact or unwelcome sexual attention
- Advocating for, or encouraging, any of the above behaviour

For more information or to report an issue, please visit:

complexity.asu.edu/conduct

Cultural Evolution Conference 2018

Tempe, AZ

Monday, October 22nd, 8:00 a.m – 5:20 p.m.

Day 1

Session	Time	Room	Topic
	7:00 AM	Ballroom Foyer	Conference Check-in Opens
	7:30 – 8:30 AM	TBD	Breakfast provided by conference
	8:00 – 8:30 AM	Ballroom	Opening Address by Pete Richerson (Society President) and Rob Boyd (Head of the Local Organizing Committee)
S1	8:30 – 9:30 AM	Dolores	Intergroup Cultural Transmission
		Ballroom	Teaching and Over-Imitation
		San Pedro	Conceptual Analysis of Theory
	9:30 – 9:35 AM		5-min Break (Snacks provided by conference)
S2	9:35 – 10:35 AM	Dolores	Tool Kit Complexity
		Ballroom	Music and Culture
		San Pedro	Explaining Cultural Variation
	10:35 – 10:40 AM		5-min Break (Snacks provided by conference)
S3	10:40 – 11:40 AM	Dolores	Norms 1
		Ballroom	Cultural Evolution of Stone Tools
		San Pedro	Cultural Learning and Individual Learning
	11:40 AM – 1:00 PM		Lunch (Provided by conference)
S4	1:00 – 3:00 PM	Ballroom	Plenary, Remarks, and Lightning Talks
	3:00 – 3:15 PM		15-min Break (Snacks provided by conference)
S5	3:15 – 4:15 PM	Dolores	<i>Special Session</i> : Culture and Economics
		Ballroom	<i>Special Session</i> : Conformism
		San Pedro	Norms 2
	4:15 – 4:20 PM		5-min Break
S6	4:20 – 5:20 PM	Dolores	Split session: Economics of Gender Roles/Culture and the Archaeological Record
		Ballroom	Group Boundaries
		San Pedro	Innovation

Intergroup Cultural Transmission – Dolores

John Bunce	Boarding schools and cultural dynamics in a multi-ethnic Amazonian population
Renée Hagen Brooke Scelza	Outgroup norm adoption among the Himba in Namibia
Richard Berl Shyamalika Gopalan Gillian Belbin Chris Gignoux	Marcus Feldman Barry Hewlett Brenna Henn Demographic and cultural history of the Chabu hunter-gatherers of southwestern Ethiopia

Teaching and over-imitation – Ballroom

Hanna Schleihauf Hoehl Stefanie	Dual-mode model for overimitation
Michelle Kline Cristina Moya Matthew Gervais Robert Boyd	Irrelevant-Action Imitation is Short-term and Social: Evidence from Two Under-studied Populations
Mark Atkinson Christine Caldwell	Inferring behavior from partial social information and the cultural transmission of adaptive traits
Masanori Takezawa Seiya Nakata	Does teaching promote the cumulative cultural evolution?: Agent-based simulations with computational models of teaching
Daniel Grunspan Michelle Kline Sara Brownell	The Lecture Machine: A Cultural Evolutionary Model of Pedagogy in Higher Education

Conceptual analysis of theory – San Pedro

Indra Gesink	Three arguments against evolution by group selection, in particular as a driver of cooperation, and a way forward
Thomas Abel	The Role of the 'Information Cycle' in Cultural Evolution
Simon Carrignon Alex Bentley Michael Aaron Gilchrist Damien Ruck	How the intrinsic value of information can change the spread of news in social media
Monica Tamariz	Cumulative culture = Darwinian cultural evolution

Tool kit complexity – Dolores

Gili Greenbaum
Marcus W Feldman
Erella Hovers
Oren Kolodny

Could an increase in population connectivity in the Levant have been the driving force of the transition to the Upper Paleolithic?

Jonathan Paige
Deanna Dytchowskyj
Charles Perreault

Measuring the complexity of stone tool technologies from the Lower Paleolithic through the Late Holocene

Alexander Allan
Dennis Sandgathe
Mark Collard

Risk and Hunter-Gatherer Toolkit Structure: A Regional Perspective from the Pacific Northwest

Alden Wright Cheyenne Laue

Smart intergroup horizontal transmission and retention of complex technological traits under environmental change

Music and Culture – Ballroom

Mason Youngblood

The cultural transmission of sampling traditions in a network of musical collaborators

Carson Miller Rigoli
Sarah Creel

Diverse individual timing biases and the emergence of musical rhythm

Bernard Koch
Daniele Silvestro
Jacob Foster

The Birth and (Brutal, Blackened) Death of Cultural Things: A Macroevolutionary History of Metal Music 1968-2000

Sally Street

Cultural evolution operates distinctly in the musical domain

Explaining Cultural Variation – San Pedro

Kathryn Kirby
Simon Greenhill
Russell Gray

Evidence for niche partitioning within and among linguistic groups

Bret Beheim

Milk consumption is globally widespread and increasing: time to rewrite the textbooks?

Fiona Jordan
Péter Rácz
Sam Passmore

Cultural evolution of kinship diversity: the micro and macro of talking about family

Norms 1 – Dolores

Dylan Hadfield-Menell
Mckane Andrus
Gillian Hadfield

Legible Normativity: The Value of Silly Rules

Øivind Schøyen

Morals favored by previous moral choices are always safer

Cristina Bicchieri

Eugen Dimant
Simon Gächter
Daniele Nosenzo

Feel the Power of the Dark Side: On the Evolution of Norm Erosion

Ehud Lamm

Norm psychology in multi-cultural societies

Cultural evolution of stone tools – Ballroom

Claudio Tennie

The best explanation for the stasis in early hominin stone tool forms is a lack of copying mechanisms

Jonathan Paige
Charles Perreault

Were Early Stone Tool Technologies Genetically Transmitted?
Comparing Passerine Nests and Acheulean Handaxes

Tamar Rosenberg-Yefet

Ran Barkai
Ehud Lamm

Where can we draw the line between individual learning and cultural transmission: the case of the Levantine Lower Paleolithic Levallois method

Cultural learning and individual learning – San Pedro

Jacob Harris

Robert Boyd
Brian Wood

Sources of variation in projectile technology among Hadza of Tanzania

Maxime Derex

Jean-François Bonnefon
Rob Boyd
Alex Mesoudi

Causal understanding is not necessary for the improvement of culturally evolving technology

Lauren Scanlon

Andrew Lobb
Jamie Tehrani
Jeremy Kendal

The effects of non-random social learning error on the cultural evolution of knots

Peter Todd

Searching cultural spaces with evolved cognitive mechanisms

Plenary – Lucy Aplin

Experimental evidence for culture and cultural evolution of foraging behaviour in birds

There is an increasing body of evidence for cultural behaviour in non-human animals. Recent work has also hypothesized that animal cultures could also exhibit some degree of cultural evolution. However we still have relatively little empirical evidence for how such processes may operate in non-human animals. In this talk, I discuss a series of studies of the within and across-generation transmission of foraging traditions in wild birds. First, I show that beneficial innovations can spread through social networks to form stable traditions. Second, that cultural traits can be both inherited and refined over time, with increasing foraging proficiency in later generations. Third, I show that traditions are flexible under environmental change, with behaviours with suboptimal payoffs less likely to survive. Finally, I explore the effect of increasing task complexity on these processes. I finish by discussing when the learnt experience of previous generations will have implications for how individuals exploit their current environment, and how these traits might be important for behavioural flexibility in changing environments.

Remarks on L.L. Cavalli-Sforza – Marc Feldman

Lightning talks

Cody Ross Bret Beheim	Estimating social learning in social networks: A longitudinal analysis of 43 years of opening strategy in a network of 1,072 top-level Chess players
Thomas Morgan Jordan Suchow Thomas Griffiths	Experimental gene-culture coevolution of human social learning in a changing environment
Gemma Mackintosh Christine Caldwell Mark Atkinson	Intentional Communication facilitates Cumulative Cultural Evolution
Dieter Lukas Andreas Ponderfer Toman Barsbai	The pervasive influence of ecology on behavioral variation
Olivier Morin James Winters Thomas Müller Tiffany Morisseau Simon J. Greenhill	The Color Game: Cultural evolution research with a gaming app
Patrik Lindenfors Fredrik Jansson Yi-Ting Wang Staffan I. Lindberg	Investigating Sequences in Ordinal Data: A New Approach With Adapted Evolutionary Models
Matthew A. Turner Paul E. Smaldino	Cultural polarization depends on whom we learn from, when we learn, and how well we communicate
Duman Bahrami-Rad Anke Becker Joseph Henrich	Tabulated Nonsense? On the Validity of the Ethnographic Atlas and the Persistence of Culture

Special Session: Culture and Economics – Dolores

Sara Lowes	Matrilineal Kinship and Spousal Cooperation: Evidence from the Matrilineal Belt
Alessandra Cassar Jane Zhang	Finding the Femina Economica
Raul Sanchez de la Sierra	Why Being Wrong Can Be Right: Magical Warfare Technologies and the Persistence of False Beliefs
Patrick Francois	Cultural Group Selection in The Workplace and the Laboratory

Special Session: Conformism – Ballroom

Andrew Whiten Stuart Watson		Conformity: Comparative and Evolutionary Studies of Primates and Other Animals
Marius Somveille Joshua Firth Lucy Aplin	Damien Farine Ben Sheldon Robin Thompson	Movement and conformity interact to establish local behavioural traditions in animal populations
Jennifer Clegg Nicole Wen Cristine Legare	Cara DiYanni Kathleen Corriveau	Cross-cultural evidence for the role of socialization in children's conformity
Sabine Nöbel Arnaud Pocheville Guillaume Isabel Etienne Danchin		Fruit flies conform in love

Norms 2 – San Pedro

Eva Kundtová Klocová	Kneeling: communication of morality or power asymmetry?
Øivind Schøyen	What Limits the Powerful in Imposing the Morality of Their Authority?

Split Session: Economics of Gender roles/Culture and the Archaeological Record – Dolores

Duman Bahrami-Rad	Keeping It in the Family: Female Inheritance, In–marriage, and the status of Women
Alessandra Cassar Mary Rigdon	Competition for influence
Kathy Schick Nicholas Toth	Cultural Evolution and the Archaeological Record
Thomas Schoenemann	Research on the evolution of language and its relationship to the archaeological record

Group boundaries – Ballroom

Karie Moorman Teenie Matlock	Magnitude of Metaphor: its effect on reasoning about immigration
Adrian Bell	Measuring Ethnic Markers in the Field Using a Classification Study
Alina Paegle Adrian Bell	Finding Potential Ethnic Markers Through a Three-Step Ethnographic Investigation
William Wimsatt	Three connected problems in theories of cultural evolution: population structure, development, and technology

Innovation – San Pedro

Emma Flynn Rachel Kendal Kayleigh Carr	Innovation takes time: Children’s novel behaviour production is aided by increased time
James Winters Thomas Müller	The emergence and evolution of structured patterns in a large-scale online collaborative art project
Peter Richerson	The Evolution of Cultural Maladaptations

Cultural Evolution Conference 2018

Tuesday, October 23rd, 8:30 a.m – 5:30 p.m.

Tempe, AZ

Day 2

Session	Time	Room	Topic
	7:30 AM	Ballroom Foyer	Conference Check-in Opens
	7:30 – 8:30 AM	TBD	Breakfast provided by conference
S1	8:30 – 9:30 AM	Dolores	Culture and Economics II
		Ballroom	Cognition
		San Pedro	Cultural History
	9:30 – 9:35 AM		5-min Break (Snacks provided by conference)
S2	9:35 – 10:35 AM	Dolores	Biases
		Ballroom	Field Studies
		San Pedro	Nonhuman Tool Use
	10:35 – 10:40 AM		5-min Break (Snacks provided by conference)
S3	10:40 – 11:40 AM	Dolores	Cognitive Variation
		Ballroom	Developmental Factors
		San Pedro	Case Studies in Cultural Evolution
	11:40 AM – 1:00 PM		Lunch (Provided by conference)
	12:00 – 1:00 PM	Campanile	Executive Committee Meeting
S4	1:00 – 3:00 PM	Ballroom	Plenary and Lightning Talks
	3:00 – 3:15 PM		15-min Break (Coffee & Tea)
S5	3:15 – 4:15 PM	Dolores	Language 2
		Ballroom	Psychology
		San Pedro	Cooperation and Morality
	4:15 – 4:30 PM		15-min Break
S6	4:30 – 5:30 PM	Ballroom	Plenary Speaker: Alison Gopnik
	6:00 – 10:00 PM	The Yard in Tempe	Dinner Party at The Yard (Tickets are Sold out)

Culture and Economics II – Dolores

Bing Han
David Hirshleifer
Johan Walden Social Transmission Bias and Investor Behavior

James Liu
Tomas Perez-Acle
Rodrigo Santibanez Simulating the Rise and Fall of Prosperity in Developed and Developing Societies

Bing Han
David Hirshleifer
Johan Walden Visibility Bias in the Transmission of Consumption Norms and Under-saving

Cognition – Ballroom

Kirsten Blakey
Christine Caldwell
Eva Rafetseder The effect of others' goals on children's strategic use of social information

Bill Thompson
Tom Griffiths A Bayesian Model of Cumulative Culture

Richard Lu
Jennifer Chatman
Amir Goldberg
Sameer Srivastava Deciphering the Cultural Code: Cognition, Behavior, and the Interpersonal Transmission of Culture

Vanessa Ferdinand Evolution and inference: how cognitive biases can be selection pressures on culture.

Cultural History – San Pedro

Hannah J. Haynie
Patrick H. Kavanagh
Fiona Jordan
et. al. Pathways to Social Inequality

Karalyn Boyer
Nicole Creanza Studying cultural and genetic variation to shed light on the migration history of the Americas

Sam Passmore
Fiona Jordan A phylogenetic approach to kinship

Biases – Dolores

Juliet Dunstone
Christine Caldwell
Mark Atkinson

The impact of executive functions on flexible decision making during social learning

Cameron Jones
Simon Kirby

The effect of biasing information on a transmission chain of short texts

Mark Atkinson
Bill Thompson
Elizabeth Renner
Gemma Mackintosh
Christine Caldwell

Robust source-independent biases in children's use of socially and individually acquired information

Richard Berl
Alarna Samarasinghe
Seán Roberts
Fiona Jordan
Michael Gavin

Tell me a story: Comparing the effects of prestige and content biases on cultural transmission

Field Studies – Ballroom

Brooke Scelza
Sean Prall

From Cows to Cash: Shifting norms among Himba pastoralists

Kristopher Smith
Tomas Larroucau
Ibrahim Mabulla
Coren Apicella

Hunter-gatherers maintain assortativity in cooperation despite high-levels of residential change and mixing

Cristina Moya

The cross-cultural development of beliefs that cultural group identities are stable

Non-Human Tool Use – San Pedro

Alba Motes Rodrigo
Parandis Majlesi
Elisa Bandini

R. Adriana
Hernandez Aguilar
Claudio Tennie

Tool excavating techniques are spontaneously reinnovated in captive task-naïve chimpanzees: implications for chimpanzee culture

Rachel Kendal
Camila Coelho

Clara Corat
Eduardo Ottoni

Experimental field investigations of cultural capacities in the, tool-using, bearded capuchin (*Sapajus libidinosus*)

Elisa Bandini
Claudio Tennie

Factors affecting spontaneous reinnovation of tool-use by primates

Jessica Fujii
Sarah Espinosa
Michael Haslam
Katherine Ralls

Michelle Staedler
Natalie Uomini
Karl Mayer
Tim Tinker

Learning and evolution of tool-use in sea otters

Cognitive Variation – Dolores

Burton Voorhees	Human Reasoning
Ryutaro Uchiyama Michael Muthukrishna	General intelligence as an Emergent Product of Cultural Complexity: Explaining the Flynn Effect
Pierce Edmiston Maxime Derex Gary Lupyan	The effects of cultural inheritance on problem solving ability
Ze Hong	Modelling the Gene-culture Coevolution of Educational Attainment in Contemporary Societies

Developmental Factors – Ballroom

Rachel Harrison Andrew Whiten	The transmission of symbolic and non-symbolic images in transmission chains of four- to eight-year-old children
Karsten Olsen Andreas Roepstorff Dan Bang	Knowing whom to learn from: Individual differences in social weighting sensitivity
Emily Little Tanya Broesch Leslie Carver Cristine Legare	Cultural Variation in Infant Emotion Expression during Dyadic Interaction
Nicole Wen Jennifer Clegg Stephanie Estrera Cristine Legare	Between- and Within-Population Variation in Beliefs About Children's Competency and Conformity

Case studies in cultural evolution – San Pedro

R. Alexander Bentley Paul Ormerod Damian Ruck	Cultural-historical dynamics of obesity in the U.S.
Sarah Peoples Joseph Watts Cara Evans Heidi Colleran	Simon Greenhill Susanne Hardecker Daniel Haun How can humans acquire cultural values? Games!
Matthew Zefferman Sarah Mathew	Gene Culture Coevolution of Combat Stress
Irene Teixidor-Toneu Jamie Thompson	Fiona Jordan Julie Hawkins Comparative phylogenetic methods and the cultural evolution of medicinal plant use

Executive Committee Meeting – Campanile

Plenary – Katie Manning Neolithic histories and cultural evolution

The origins and spread of agricultural economies had an enormous impact on human history, correlating with fundamental changes in demography, ecology and social organization. By taking an evolutionary perspective of the interactions between population, subsistence and socio-cultural traditions, recent work undertaken by myself and colleagues at UCL has shed important new light on the processes of Neolithization in Europe and beyond. Specifically, our research aimed to test the Neolithic Demographic Transition (NDT) hypothesis, which proposed a major demographic shift during the transition from forager-horticulturists to farmers, which can be explained by increased maternal energetics of farming communities relative to mobile foragers. However, whilst our research supports the NDT hypothesis, we also revealed that the reproductive advantage offered by farming was not continuous, and that most regions in Europe suffered consecutive population booms and busts. In this talk I will outline key findings of the EUROEVOL project, focusing on the expansion of the farming 'niche' and evolutionary demography of Neolithic western Europe.

Lightning talks

Andone Gurruchaga	A demographic-structural hypothesis for Tiwanaku state collapse
Francesca Luberti Robert Brooks Khandis Blake	The Opposition to Same-sex Marriage in the USA and Australia: An Experimental Test of Evolutionary and Economic Hypotheses
Elena Miu Thomas Morgan	A model of demography and cumulative culture
Erick Oduniyi Vanessa Ferdinand	Emotion extraction in stories through sentiment analysis and physiological sensing
Sean Roberts	The Causal Hypotheses in Evolutionary Linguistics Database: A tool for effective research in cultural evolution
Mason Youngblood David Lahti	A bibliometric analysis of the interdisciplinary field of cultural evolution
David Buss William von Hippel	Do Psychological Adaptations Impede Understanding the Foundations of Cultural Evolution?
Bailey House Joan Silk Patricia Kanngiesser Clark Barrett Alejandro Erut Andrew Marcus Smith	Tanya Broesch Senay Cebioglu Alyssa Crittenden Sheina Lew-Levy Carla Sebastian-Enesco Süheyla Yilmaz Universal norm psychology and the origins of societal diversity in prosocial behavior

Elizabeth Renner

Delia Couper
 Donna Kean
 Mark Atkinson
 Christine Caldwell

Capuchin monkeys' (*Sapajus apella*) and human children's (*Homo sapiens*) use of information from social, virtual, and individual sources in a stimulus choice task

Deeya Mitra

Jeffrey Arnett

Developmental Tasks of Emerging Adults from India

Cara Evans

Joseph Watts
 Russell Gray

Did intergroup warfare drive the evolution of within-group cohesion and complexity in traditional Austronesian societies?

Day 2, Session 5:

Tuesday, October 23rd, 3:15 – 4:15 p.m

CES 2018

Tempe, AZ

Language 2 – Dolores**Limor Raviv**

Antje Meyer
 Shiri Lev-Ari

Network structure and the cultural evolution of linguistic structure: An artificial language study

Stuart Watson

Jutta Mueller
 Shen Yang Chong

Susan Lambeth
 Steven Schapiro
 Simon Townsend

Non-adjacent dependency processing in humans, apes and monkeys using an artificial grammar paradigm.

Gary Lupyan

Population size and the evolution of linguistic redundancy

Arturs Semenuks

What makes a language violate universals? Correlates of linguistic rarities and their importance in studying linguodiversity

Psychology – Ballroom**Paul Smaldino**

Aaron Lukaszewski

Christopher von Rueden
 Michael Gurven

A Socioecological Model of Personality Trait Distributions

**Jonathan Schulz
 Joe Henrich**

Duman Bahrami-Rad
 Jonathan Beauchamp

The Origins of WEIRD People

Joshua Conrad Jackson

Joseph Watts
 Teague Henry
 Johann-Mattis List

Robert Forkel
 Simon Greenhill
 Russell Gray
 Kristen Lindquist

Human Emotion Across 1156 Languages: An Analysis Using Concept Colexification

Gwendolyn Gardiner

David Funder

Geographic Predictors of Personality Traits

Cooperation and Morality – San Pedro (con't Day 2, Session 5)

Marcel Harmon		The Owner Project Requirement's Document as a Tool of Cooperation
Joshua Rottman	Anastasiia Grigoreva	Selective Trust and Positive Evaluations of Clean Informants Across Development and Culture
Angie Johnston	Grigoreva	
Sydney Bierhoff	Josie Benitez	
Taisha Pelletier	Prsni Patel	
Daniel Kelly		Cultural Evolution, Norm Change, and Moral Progress
Joaquin Poblete		The Evolution of Productive Organizations
Francisco Brahm		

Day 2, Session 6:
Tuesday, October 23rd, 4:30 – 5:30 p.m

CES 2018
Tempe, AZ

Plenary Speaker – Alison Gopnik

Childhood as a solution to explore-exploit dilemmas: Life history, learning and cultural evolution

I will present several studies showing that preschoolers can learn abstract higher-order principles from data, as well as studies of adolescents, low SES American and Peruvian children, and Peruvian adults on the same tasks. In each case, younger learners were actually better at inferring unusual or unlikely principles than older learners. I will also include preliminary evidence from Amazonian horticulturalists. I relate this to computational ideas about search and sampling, to evolutionary ideas about human life history, and to neuroscience findings about the negative effects of frontal control on wide exploration, and the advantages of earlier neural architectures for wide-ranging learning. My hypothesis is that childhood is evolution's way of performing simulated annealing. Our distinctively long human childhood allows a period of broad "high-temperature" hypothesis search. As a result, this life-history allow humans to escape from local optima in the course of cultural evolution.

Cultural Evolution Conference 2018

Tempe, AZ

Wednesday, October 24th, 8:30 a.m – 5:20 p.m.

Day 3

Session	Time	Room	Topic
	7:30 AM	Ballroom Foyer	Conference Check-in Opens
	7:30 – 8:30 AM	TBD	Breakfast provided by conference
S1	8:30 – 9:30 AM	Dolores	Language 1
		Ballroom	Formal Models of population dynamics
		San Pedro	Case studies 1
	9:30 – 9:35 AM		5-min Break (Snacks provided by conference)
S2	9:35 – 10:35 AM	Dolores	Primate social learning 1
		Ballroom	Cooperation
		San Pedro	Archaeology
	10:35 – 10:40 AM		5-min Break (Snacks provided by conference)
S3	10:40 – 11:40 AM	Dolores	Cultural Evolution in Non-humans
		Ballroom	Supernatural beliefs and cooperation
		San Pedro	Cultural learning 1
	11:40 AM – 1:00 PM		Lunch (Provided by conference)
S4	1:00 – 3:00 PM	Ballroom	Plenary and lightning talks
	3:00 – 3:15 PM		15-min Break (Snacks provided by conference)
S5	3:15 – 4:15 PM	Dolores	Non-primate social learning 1
		Ballroom	Supernatural beliefs 1
		San Pedro	Ways of thinking about Cultural Evolution
	4:15 – 4:20 PM		5-min Break
S6	4:20 – 5:20 PM	Dolores	Non-primate social learning 2
		Ballroom	Supernatural beliefs 2
		San Pedro	Cultural dynamics
GM	5:30 – 7:30 PM	Ballroom	General Membership Meeting

Language 1 – Dolores

Katie Mudd Yannick Jadoul	Connie de Vos Bart de Boer	Investigating the factors maintaining sign languages using an agent based model
Gerd Carling Sandra Cronhamn Harald Hammarström		Can semantic evolution be predicted? A case study on the Eurasian vocabularies for hunting, farming, and technology
Marco Tulio Coelho Elisa Pereira Hannah Haynie Thiago Rangel Patrick Kavanagh Kathryn Kirby	Russell Gray Simon Greenhill Claire Bower Robert Colwell Nicholas Evans Michael Gavin	Drivers of geographic patterns of North American language diversity
Hettie Roebuck Gary Lupyan		Language and intelligence: the role of 'nameability' in fluid intelligence.

Formal Models of Population Dynamics – Ballroom

Hillary Lenfesty Thomas Morgan	Modelling cultural evolutionary dynamics of prestige-biased copying
Marco Smolla Erol Akcay	How cultural dynamics affect population structure
Alden Wright Cheyenne Laue	Inter-group cultural transmission and cumulative culture

Case Studies 1 – San Pedro

Nicole Fider Natalia Komarova	Quantitative studies of color categorization and category evolution
James Winters Piers Kelly Helena Miton Olivier Morin	Compression effects in the cultural evolution of the Vai script of West Africa
Jay Baldwin	Cop Art: The Evolutionary Origins of the Police Procedural Narrative Form
Olivier Morin Barbara Pavlek James Winters	The evolution of money: How information grew on ancient coins (Greece 650-30 BCE)

Primate Social Learning 1 – Dolores

Axelle Bono
Andrew Whiten
Carel van Schaik
Michael Krützen

Franca Eichenberger
Alessandra Schneider
Erica van de Waal

Payoff- and sex-biased social learning interact in a wild primate population

Eduardo B Ottoni

The lasting and the passing: behavioral traditions and opportunities for social learning in wild tufted capuchin monkeys (*Sapajus* spp.)

Stuart Watson
Gillian Vale
Lydia Hopper
Lewis Dean
Rachel Kendal

Elizabeth Price
Sarah Davis
Steven Schapiro
Susan Lambeth
Andrew Whiten

Chimpanzees demonstrate individual differences in social information use

Donna Kean
Elizabeth Renner
Mark Atkinson
Christine Caldwell

Capuchin monkeys can learn and generalise a win-stay, lose-shift strategy under social information and individual exploration conditions

Cooperation – Ballroom

Timothy Waring
Taylor Lange

Afton Hupper
Ethan Tremblay

Ephemeral Cooperation in the Evolution and Development of Food Cooperatives

William Baum
Peter Richerson

Evolution of Cooperation in the Laboratory-II

Charlotte Brand
Alex Mesoudi

Is there evidence of prestige and dominance-based social hierarchies in naturally-occurring local community groups?

Aaron Lightner
Edward Hagen

Simulating strategic defection in need-based transfers: A re-analysis of risk-pooling and herd survival

Archaeology – San Pedro

Bruno Vilela
Trevor Fristoe
Ty Tuff
Michael Gavin

Patrick Kavanagh
Hannah Haynie
Russel Gray
Carlos Botero

Domesticates Ecological Niches Limited the Historical Transmission of Farming

Kohei Tamura
Takehiko Matsugi

Geometric Morphometrics of Keyhole-Shaped Mounds

Mark Collard
Chris Carleton

Brea McCauley
Andre Costopoulos

An evolutionary agent-based model contradicts Dunnell's version of the waste hypothesis for cultural elaboration

Brea Mccauley
David Maxwell
Mark Collard

Upper Palaeolithic handprints with missing fingers: an ethnological perspective

Cultural Evolution in Non-Humans – Dolores

Elizabeth Hobson	The evolution of socio-cultural conflict strategies
Gareth Roberts Robin Clark	Production, perception, and the dynamics of signaling systems
Susan Perry Brendan Barrett Irene Godoy	Behavioral innovation in wild white-faced capuchin monkeys, <i>Cebus capucinus</i> , at Lomas Barbudal, Costa Rica.

Supernatural Beliefs and Cooperation – Ballroom

Joseph Watts Oliver Sheehan Russell Gray Joseph Bulbulia	The evolution of secular and religious leadership were tightly coupled and mutually reinforcing in early Austronesian societies
Felipe Valencia Caicedo	Christ's Shadow: Non-Cognitive Skills and Prosocial Behavior Amongst the Guarani
Mark Stanford	Religious orthodoxy and folk traditions sustain complementary forms of co-operation: Evidence from Burmese Buddhists
Cindel White Ara Norenzayan	Mental models of supernatural morality

Cultural Learning 1 – San Pedro

Cameron Turner	The Coevolution of Adaptations for Social Learning
Johan Kamal Monica Tamariz	Vertical and horizontal transmission of cultural traits in Malaysian and British students
Michael Chimento Christine Cuskley Simon Kirby	Modeling Strangers: Population size, fluidity, and complexity in shared cultural systems
Charlotte Wilks Gemma MacKintosh Eva Rafetseder Elizabeth Renner Christine Caldwell	Find the treasure: Children's use of social information in a Stimulus Selection Task

Plenary – Nathan Nunn

On the Causes and Consequences of Cultural Variation: Perspectives from Economic History and Development Economics

The talk will provide an overview of recent and ongoing research that seeks to better understand the historical determinants of cultural differences that we observe in the world today. I will also consider the question of how this variation matters for the economic and social well-being of societies. Finally, I will illustrate the importance of understanding cultural differences, and their origins, for policymakers, governments, and NGOs.

Lightning talks

Leonid Tiokhin Minhua Yan Thomas Morgan	Competition for Priority and the Natural Selection of Bad Science
Andrew Shtulman Cara Neal Gabrielle Lindquist	Children's Ability to Learn Evolutionary Explanations for Biological Adaptation
Cristine Legare	Anthropomorphizing science: How does it affect the development of evolutionary concepts?
John Opfer	Knowing What Students Know About Cultural Evolution: Insights from Biology Education
Taylor Davis	Internalized Norms and Taboo Tradeoffs: Taking the Sacred Out of "Sacred Values"
Radek Kundt	Effects of religious auditory cues on dishonest behavior
Aiyana Willard Joanathan Jong Harvey Whitehouse	Rewarding the Good and Punishing the Bad: the moral importance of karma and afterlife beliefs in Singaporean Chinese culture
Lluís Oviedo Hansgeorg Hemminger	The enigma of religion's cultural evolution
Kirsten Lesage Rebekah Richert	Can God Make the Impossible Improbable? Anthropomorphism and Children's Belief that God Can Do the Impossible

Non-Primate Social Learning 1 – Dolores

Robin Clark
Steven Kimbrough

Exploring Honeybee Models of Social Learning

Catherine Sheard
Sally E Street
Mary C Stoddard
Camille Troisi

Andrew Clark
Susan D Healy
Kevin N Laland

The evolutionary flexibility of animal construction: the co-evolution of bird nests and bird eggs

Thibaud Gruber
Dora Biro

Efficiency as a driver of cumulative cultural evolution: from birds to primates

Supernatural Beliefs 1 – Ballroom

Manvir Singh

Magic, explanations, and evil: On the origins and design of witches and sorcerers

Carol R Ember
Ian Skoggard

Resource Stress, Beyond-Household Sharing, and the Involvement of Gods

Michael Muthukrishna

The Evolution of Evil Eye Beliefs and Related Behaviors

Peter Maño
Dimitris Xygalatas

Ritual signaling as an adaptation- and status management strategy in a Tamil-Hindu religious group in Mauritius

Ways of thinking about Cultural Evolution – San Pedro

Alexandra Nikolic
Ellen Mok
Jesse Brinkman
Igor Nikolic

Exploring object-based learning in museums through agent-based modelling

Luke Matthews

Toward a robust statistical toolkit for cultural evolutionary modeling

Francys Subiaul

Summative learning as a mechanism for cultural evolution

Colin Allen

The cognitive paleoethology of expertise

Non-Primate Social Learning 2 – Dolores

Jenny Allen Ellen Garland Rebecca Dunlop Michael Noad	Cultural revolutions reduce complexity in the songs of humpback whales.
Natalie Uomini Russell Gray	Cumulative and mosaic tool evolution within New Caledonian crows
Damien Neadle Matthias Allritz Claudio Tennie	Non-human “culture” – An example of cultural simplicity in action, including a soft (minimal) definition of culture).
Ellen C. Garland Luke Rendell M. Michael Poole Michael J. Noad	When revolutions fail: understanding the underlying mechanisms of humpback whale song revolutions through investigating failures

Supernatural Beliefs 2 – Ballroom

Rohan Kapitany Christopher Kavanagh Harvey Whitehouse	The Structural Model of Ritual
Swayze Hansen Adrian Bell	Increased Presence of Cultural Markers in Constructing Iconoclastic Religious Identities

Cultural Dynamics – San Pedro

Amir Goldberg Sarah Stein	Beyond "Social Contagion": Associative Diffusion and the Emergence of Cultural Variation
Miran Božičević	Cultural evolution of social power: autocatalysis and random grammar models
Barend van Heusden	Modeling the dynamics of cultural complexity

General Membership Meeting – Ballroom

The General Membership Meeting is important for a young society such as ours. The Executive Committee has a number of ideas about our future on which we need your feedback. We are also confident that Members will have ideas we all need to discuss. Please attend!

PROMOTING DIVERSITY IN QUESTION ASKING

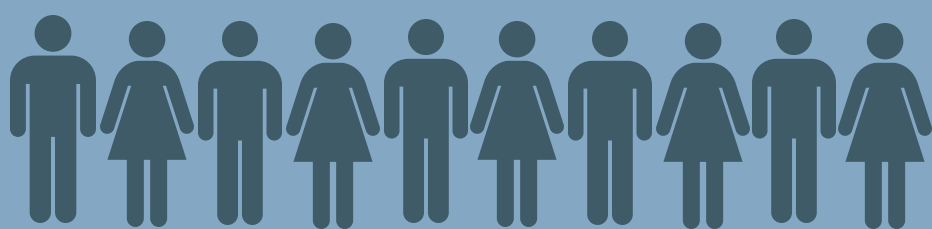

1 in 2 audience members in academic seminars are women.

But for every question asked by a woman, men ask 2-3 times as many

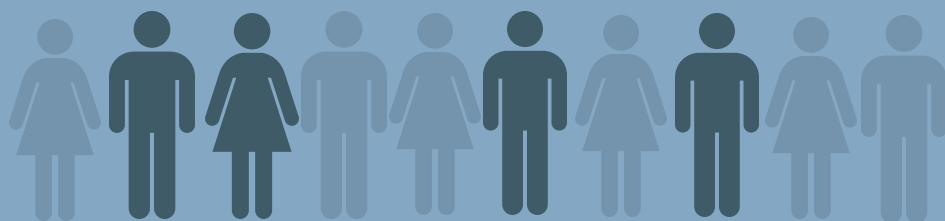

Visibility matters: people tend to judge whether they "belong" in a career based on who they see in it. Low visibility may lead to the attrition of women and other minorities in academia.

FINDING: WHEN MORE QUESTIONS WERE ASKED, THE GENDER BALANCE IN THE QUESTIONS FROM THE AUDIENCE INCREASED*



TIPS: **Organisers:** Allow more time for questions after a seminar

Moderators: Keep questions and answers short; intercept 'showing off' questions or comments

Audience: Ask questions after talks; save statements and comments for after the talk

FINDING: WOMEN REPORT FEELING MORE NERVOUS THAN MEN ABOUT ASKING QUESTIONS, BUT MEN GET NERVOUS, TOO



TIPS: **Organisers:** Allow a small break for time to formulate questions

Moderators: Be encouraging and keep an eye peeled for questions from less confidently-raised hands

Audience: Recognise that many others feel the same way as you; it's ok to feel nervous!

FINDING: PROPORTIONALLY MORE WOMEN ASKED QUESTIONS WHEN THE FIRST QUESTION CAME FROM A FEMALE*



TIPS: **Organisers:** State expectations for behaviour that supports inclusivity

Moderators: Choose someone who would normally not ask a question first, if possible.

Audience: Consider holding onto your question briefly, to provide an opportunity for someone whose voice is heard less often

*these data are correlational, but the tips can't hurt to implement, just in case

for more tips, go here: <http://diversityinacademia.strikingly.com/>